



Accessory Name – KNEE PAD KIT

Model – BSA GOLDSTAR 650

Genuine Motorcycle Accessory Fitment Instructions

WARNING: BSA genuine accessories are designed to fit only the specific BSA motorcycle(s) that are specified above. They should not be fitted to any other type of motorcycle. Pay particular attention to the warnings & cautions contained in this instruction. Failure to do so may result in an incorrect installation of the accessory which could result in an unsafe riding condition and possible accident. If any doubt always seek help from your authorised BSA dealer.

WARNING: Before starting any accessory kit installation ensure the motorcycle is supported in a stable condition. Failure to support the motorcycle correctly could lead to motorcycle damage or personal injury.

WARNING: All fixings must be tightened to the torque values specified in this instruction. Failure to tighten fixings to correct torque could result in an unsafe riding condition and possible accident.

CAUTION: Care should be taken when fitting any accessory kit. Incorrect handling of kit components or the use of incorrect tools could lead to component or motorcycle damage.

NOTE: The content of this instruction is subject to change at any time without notice or liability. BSA reserves the right to revise the information presented at any time.

T10000B10170N-KNEE PAD KIT

1

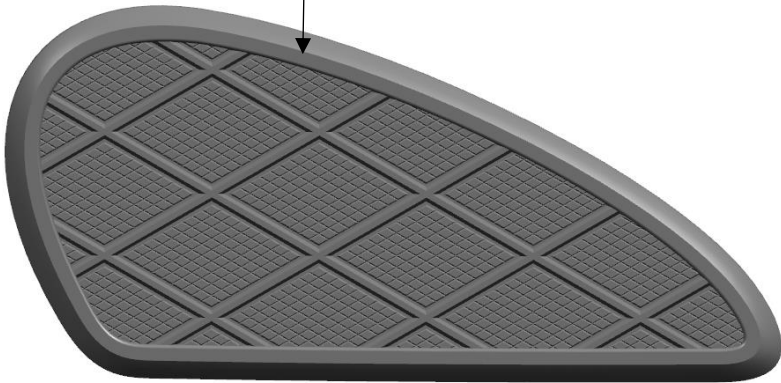

2

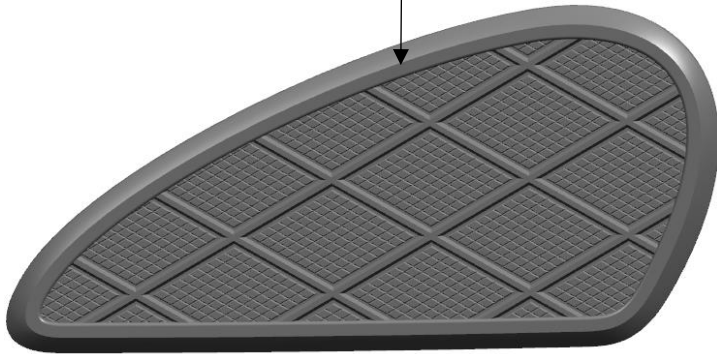

3

Item	Part no	Description	Qty
1	T14000B10100N	KNEE PAD - LH	1
2	T14000B10110N	KNEE PAD - RH	1
3	-	CLEANING WIPE	1

Fitment with Standard Tank:

Note:

- To prevent burns, allow the engine, exhaust system, radiator, etc., to cool before installing the accessory.
- Take care not to damage the painted surfaces of the motorcycle.
- Once the knee pads have been fitted, they will become an integral part of the fuel tank & cannot be removed.
- Read the warning notices printed on the cleaning wipe packet.
- The surface to which the knee pads are affixed must be clean and dry to ensure that the adhesive has a sound base to adhere to. Use the cleaning wipe supplied for this purpose.

1. Using the cleaning wipe provided, clean the areas on the side of the fuel tank shown below.

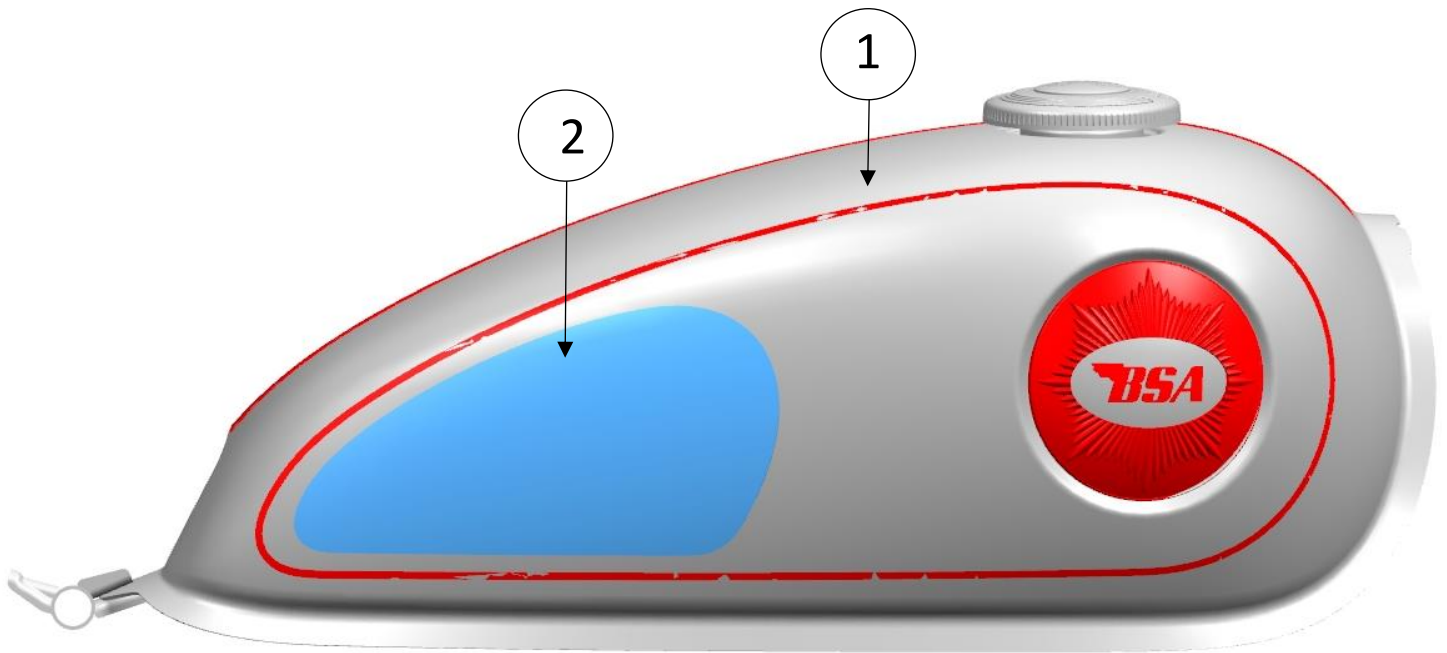

1. Fuel tank
2. Cleaning area, right hand side shown

2. Print out attached template pdf file on A3 paper, which contains the alignment template for correct positioning of the accessory knee pads.
3. Carefully cut out the template.
4. Attach the alignment template to the right-hand side of the fuel tank with masking tape aligning the template with the chrome decal in the fuel tank as shown.

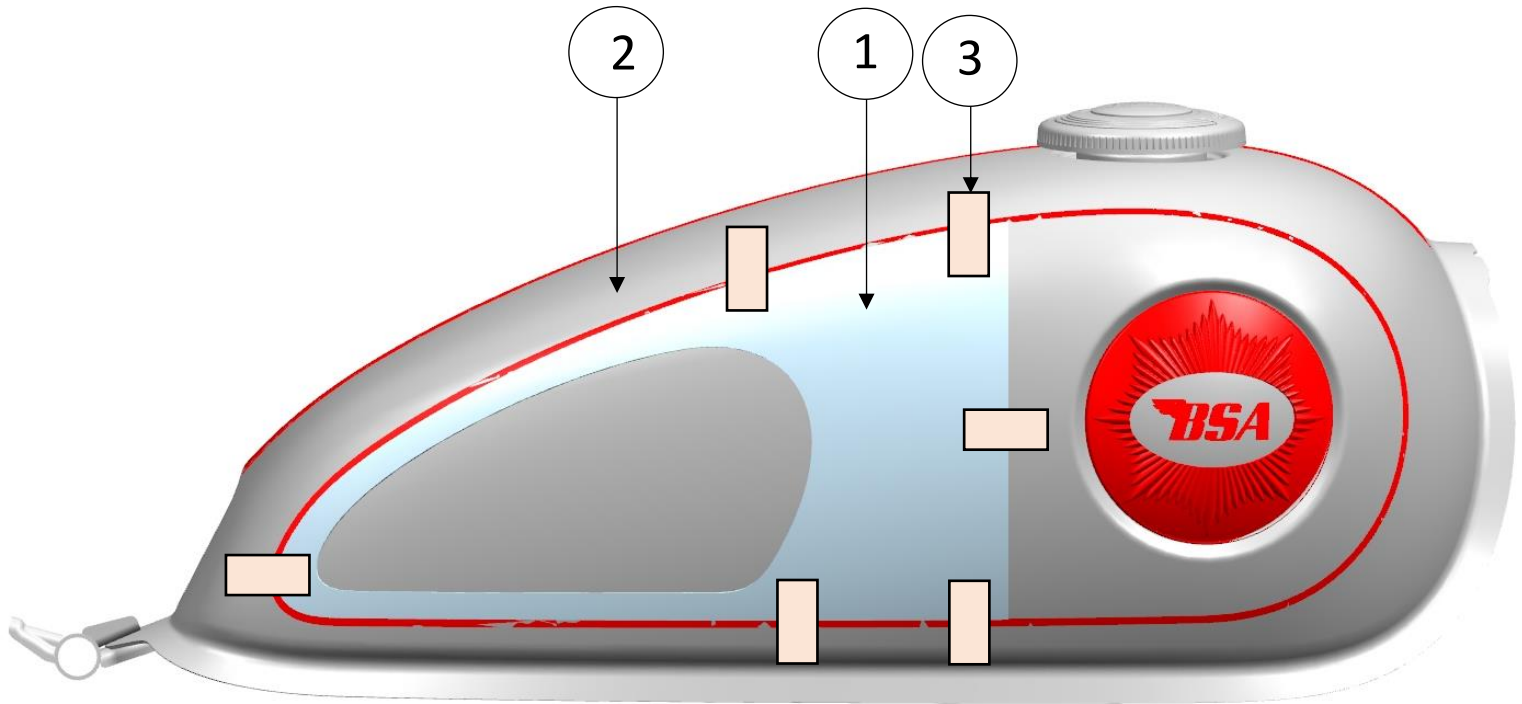

1. Template
2. Masking tape
3. Chrome decal

5. Collect the right-hand knee pad from the kit.

CAUTION: When fitting self-adhesive parts, care must be taken to ensure positioning is correct & accurate. Once the adhesive has been attached to the mounting surface, there is no satisfactory method of removal and repositioning if incorrectly aligned. Initial bonding is instant, full bonding is achieved after 72 hours.

6. Peel away the adhesive backing strips from the right-hand knee pad.

7. Carefully position the right-hand knee pad on to the fuel tank aligned with the inner cut out section of the alignment template, in the orientation shown. Apply firm and even hand pressure across the whole knee pad surface for one minute to ensure a good bond is achieved.

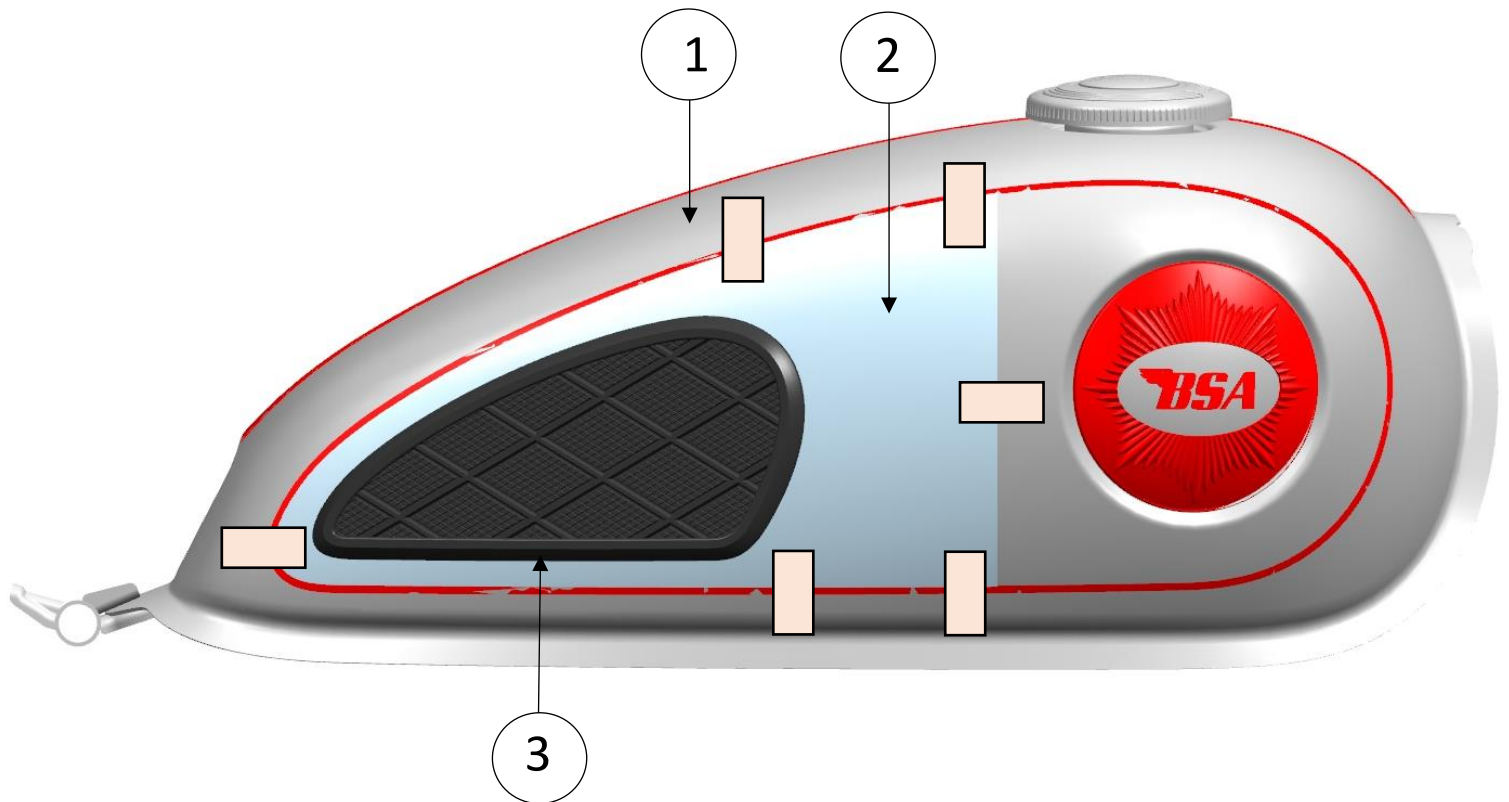

1. Fuel Tank
2. Inner cut out, alignment template
3. Knee pad, right hand

8. Carefully remove the template from the fuel tank.

Note: If the template becomes damaged when it is removed from the fuel tank repeat steps 2 and 3 to produce a new template.

9. Repeat steps 4 to 8 for the left-hand knee pad.

⚠ WARNING: After fitting any genuine BSA accessory always ride the motorcycle with caution and allow time to become familiar with any change in the motorcycle handling characteristics. Failure to become familiar with any change in the motorcycle handling characteristics may cause the motorcycle to become unstable and result in an accident.